

FELICIA

R35 Lubricating Oil Pump

R35 系列预润滑油泵

Areas of Application

应用领域

- FELICIA Gear Pumps are used primarily in oil hydraulics, lubrication technology and for the transport of various oils or lubricating substances.

FELICIA 预润滑油泵用

于液压、润滑系统，以

及用于输送各类油或是

润滑液的装置。

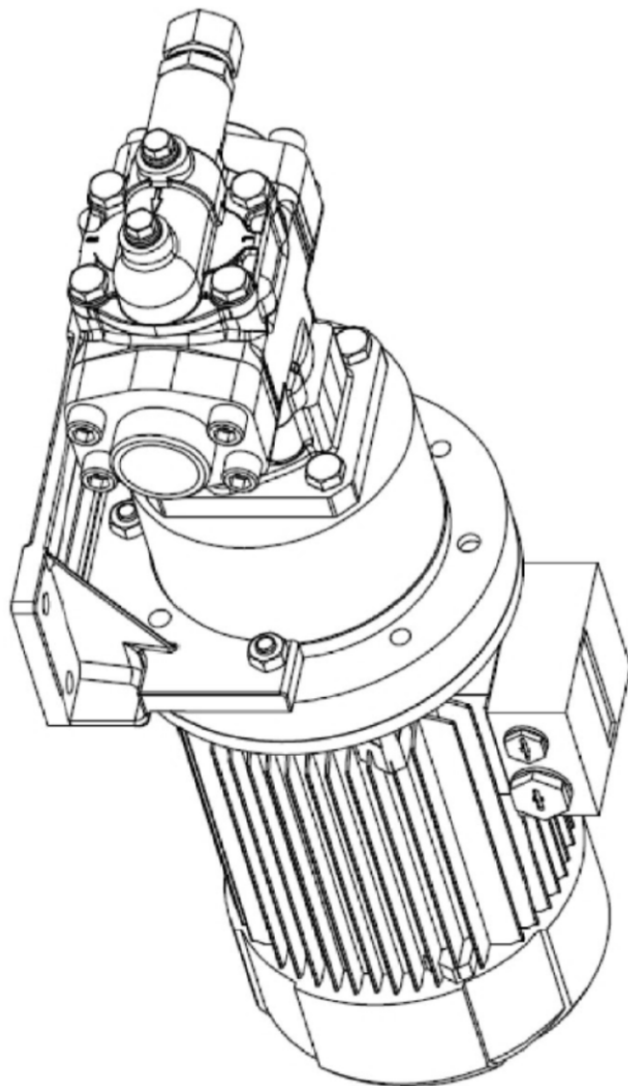

Advantage 优点

- Description: Gear Pump, Pressure Relief Valve
描述：齿轮式结构，限压阀

FELICIA

雨凡机械科技（上海）有限公司

Yufan Machinery Technology(Shanghai) Co., Ltd.

地址：上海市青浦区新金路 123 号 F 栋 2 楼 邮编：201700

Mobile: +86-18817887163 Tel: +86-21-59283219

Fax: +86-21-69767217 E-mail: mike@yfstart.com

Lubricating Oil Pump 预润滑油泵

1. Application Examples 应用案例

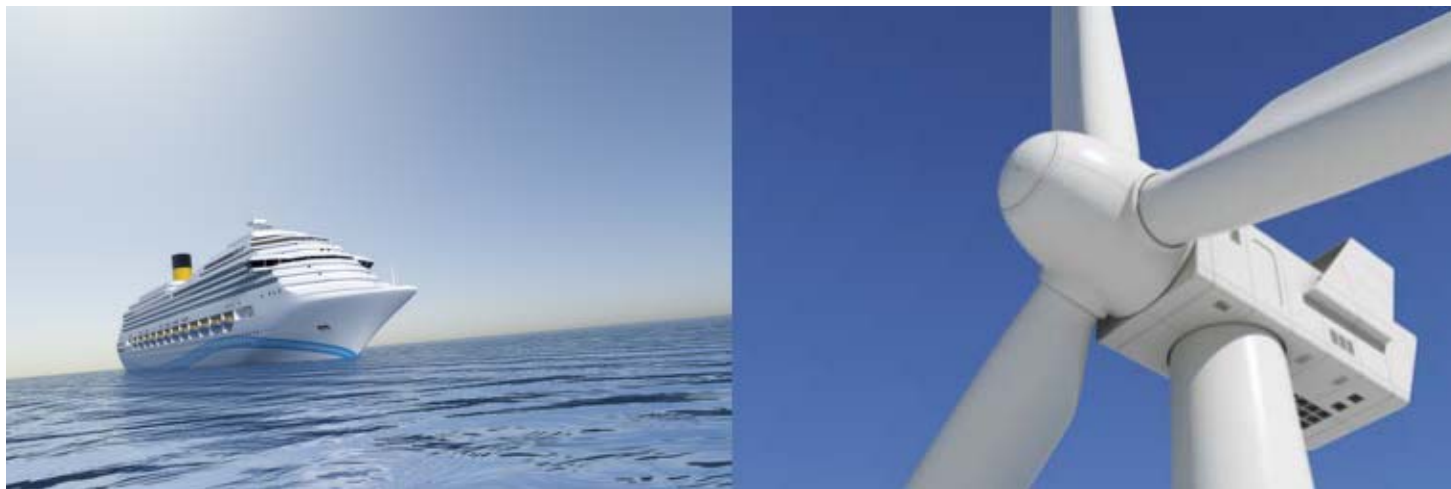

2. Pump Structure Diagram 泵结构图

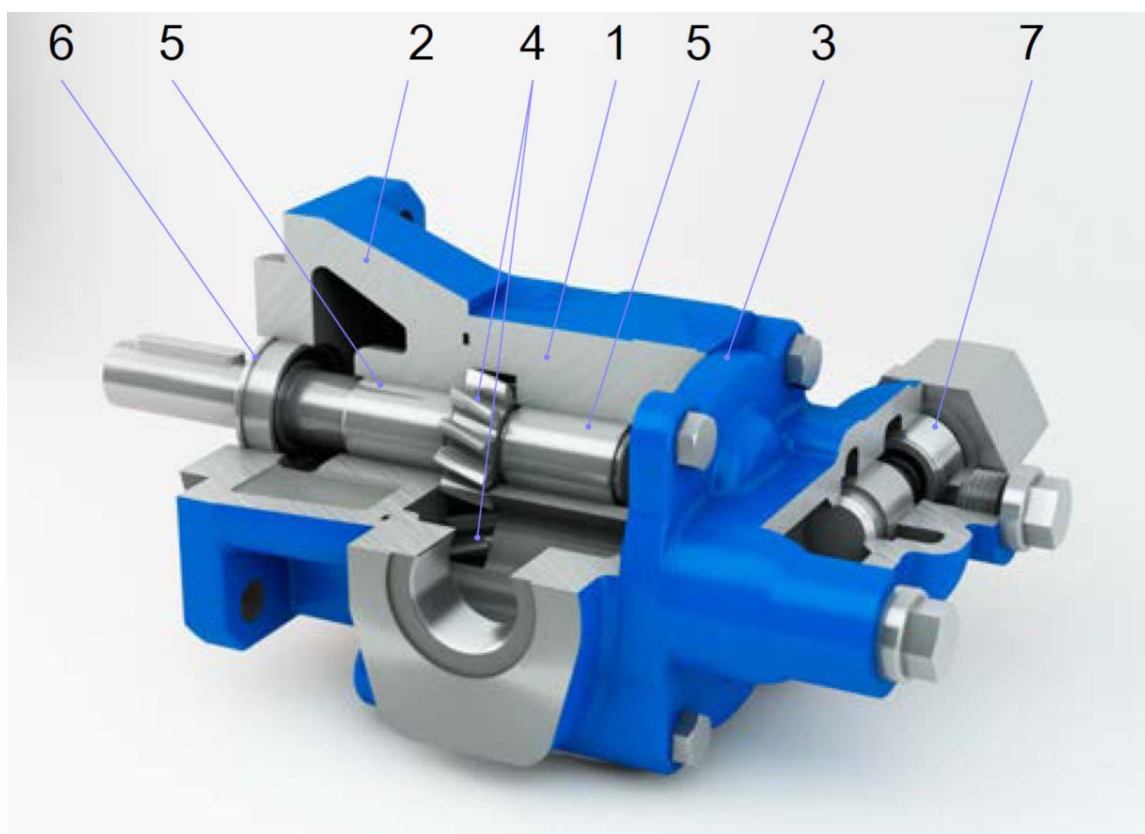

1. Gear casing 2 Driving cover 3 End cover 4 Hardened gear shafts 5 Bearing 6 Radial shaft seal 7 Pressure relief valve

1. 泵壳体 2. 上盖罩 3. 下封闭盖 4. 齿轮轴 5. 轴承 6. 密封圈 7. 限压阀



雨凡机械科技（上海）有限公司
Yufan Machinery Technology(Shanghai) Co., Ltd.

Lubricating Oil Pump 预润滑油泵

3. Product Description 产品说明

FELICIA gear pumps are characterised by a simple and robust structure. Short, straight flow channels ensure good priming characteristics and quiet running. Together with a special design of the tothing and the gear casing, an extremely low noise level is ensured during operation.

The casings of the standard version are made of grey cast iron, the gear parts of hardened steel. Generously dimensioned, specially coated multicomponent friction bearings have a long service life and very good dry-running properties.

The shaft seal is designed as standard with a radial shaft seal. In addition, numerous sealing variants are possible (such as a mechanical seal).

FELICIA 齿轮泵的特点是结构简单、稳固可靠，流体导向通道短而直，结合独特的齿轮箱结构和特殊齿形结构，这样既可以保证出色的吸入性能，又可保证运行过程中噪音水平极低。

标准壳体由铸铁制成，传动部件材质为经硬化处理的表面渗碳钢。大尺寸、带有特殊涂层的符合材料华滑动轴承拥有较长的使用寿命，并具有极优良的干运行特性。

4. Functioning principle 工作原理

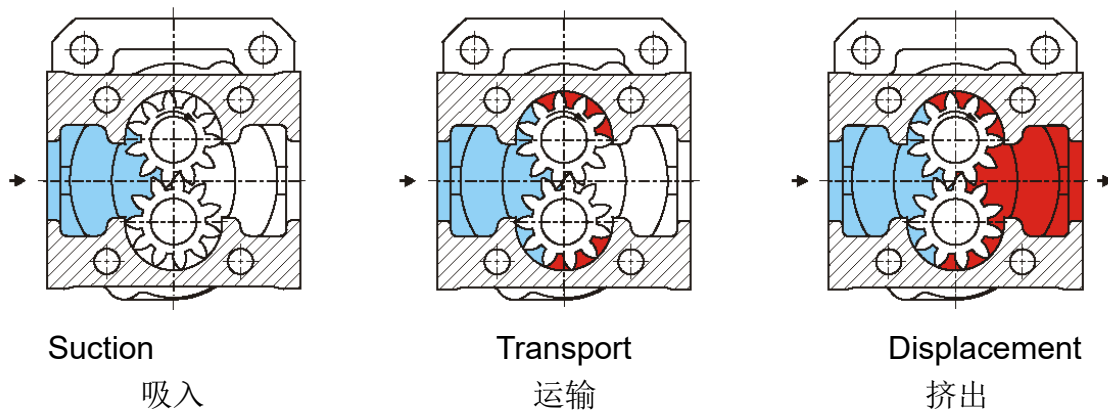

FELICIA

雨凡机械科技（上海）有限公司

Yufan Machinery Technology(Shanghai) Co., Ltd.

Lubricating Oil Pump 预润滑油泵

Gear pumps are rotary displacement pumps. When the gear shafts turn, the medium enclosed in the space between the teeth is transported from the suction to the pressure side. Then the medium is displaced toward the pressure side by the intermeshing teeth. The transport of the flow medium results in a pressure drop on the suction side of the gear pump. The flow medium compensates for this pressure drop by flowing in, thereby maintaining the feed process.

This process is the same for both gaseous and liquid media. As a result, the gear pump is capable of priming the suction pipe itself until it is completely filled with liquid flow medium.

齿轮泵是一种回转型容积式泵。当齿轮转动时，齿轮脱开侧的空间的体积从小变大，形成真空，将液体吸入，齿轮啮合侧的空间的体积从大变小，将液体挤入管路中去。由于齿的不断啮合，这一现象就连续发生，从而形成连续的输送过程。

该过程对于气态和液体的介质执行方式都相同。因此齿轮泵可以自行给吸入侧排气，直到整个管内都填满液体输送介质为止。

Note 提示:

The venting of the suction line is not possible under the following conditions:

- The suction line is leaking which means that a vacuum cannot develop.
- The pressure in the suction-side pipeline system and/or tank is too low to allow a subsequent flow of the pumped medium. This is possible if a vacuum is present or if the liquid level is too far below the gear pump.
- On the pressure side of the gear pump, a non-return valve is installed (provide a bleeder valve).

以下条件下无法给吸入侧排气:

- 吸入侧不密闭，无法建立负压。
- 吸入侧管道系统或容器中的压力过低，从而不允许输送介质补入。真空条件下或者齿轮泵下方的液位距离齿轮泵过远时，就可能出现这种情况。
- 齿轮泵的压力侧安装了一个止回阀（设有排气阀）。

5. Specifications 性能参数

Part No. 型号:	R35/25-90S2		R35/40-100L2	
Gear Pump 齿轮泵:	R35/25		R35/40	
3-PH. Squirrel-cage AC Motor 三相交流电机:	90S2		100L2	
Frequency 频率:	50 Hz	60Hz	50 Hz	60Hz



雨凡机械科技（上海）有限公司
Yufan Machinery Technology(Shanghai) Co., Ltd.

Lubricating Oil Pump 预润滑油泵

Volume Of Flow 流量:	72L/min	87L/min	115L/min	139L/min
Claw Coupling 联轴器:	KA055			
Bracket 支架:	PT200			
Suction Connection 吸油口连接方式:	SAE-welding flange FSAE1.1/2GS			
Pressure Connection 压油口连接方式:	SAE-welding flange FSAE1.1/2GS			
Pump Data 泵参数:				
Pumping Medium 泵送介质:	Mineral Oil 矿物油			
Fluid Temperature 流体温度:	+5°C - +90°C			
Kin. Viscosity 运动粘度:	105-145 mm²/s (Max. 400 mm²/s)			
Inlet Pressure 进口压力:	±0.4 Bar			
Pressure Rise 压升:	2 Bar			
Max. Operating Pressure 最大工作压力:	25 Bar			
Max. Speed 最高转速:	3600 RPM			
Sense of Rotation(Seen on Shaft end) 旋向 (从轴末端看):	CCW			
Requested Driving Power 功率:	1.5 kW/2 kW (2 Bar, 400 mm²/s)		3kW (2 Bar, 400 mm²/s)	
Pressure Relief Valve 压力安全阀:	Yes (with Internal Backflow) 有 (带内泄功能)			
Opening Pressure(Valve) 开启压力 (阀):	2.5 Bar			
End Pressure(Valve) 端压力 (阀):	Approx. 4.5 Bar			



雨凡机械科技(上海)有限公司
Yufan Machinery Technology(Shanghai) Co., Ltd.

Lubricating Oil Pump 预润滑油泵

Pressure Range(Valve) 压力范围 (阀):	1-4 Bar			
Motor Data 电机参数:				
Type 型号:	90S2		100L2	
Explosion Protection (Motor) 防爆等级:	Without 无			
Frequency 频率:	50 Hz	60Hz	50 Hz	60Hz
Protection 防护等级:	IP55			
Rated Voltage 电压:	220V/380V	250V/440V	220V/380V	250V/440V
Speed 转速:	2880 RPM	3480 RPM	2880 RPM	3480 RPM
Power 功率:	1.5 kW	1.8 kW	3 kW	
Cable Entry 填料函进线规格:	2x M24*1.5 (Plugs) 10~14			
Performance 功能:	Marine Type Version 船级社认证			
Acc. to the Rules of: 符合:	ABS, CCS without specific test certificate ABS, CCS 形式认可, 不含产品认可			
Approx. Net Weight Pumpunit 重量	26 kg		35 kg	
Other Motor Available 其他电机可选				

6. Dimensions of Lubricating Oil Pump 预润滑油泵尺寸



雨凡机械科技（上海）有限公司
Yufan Machinery Technology(Shanghai) Co., Ltd.

Lubricating Oil Pump 预润滑油泵

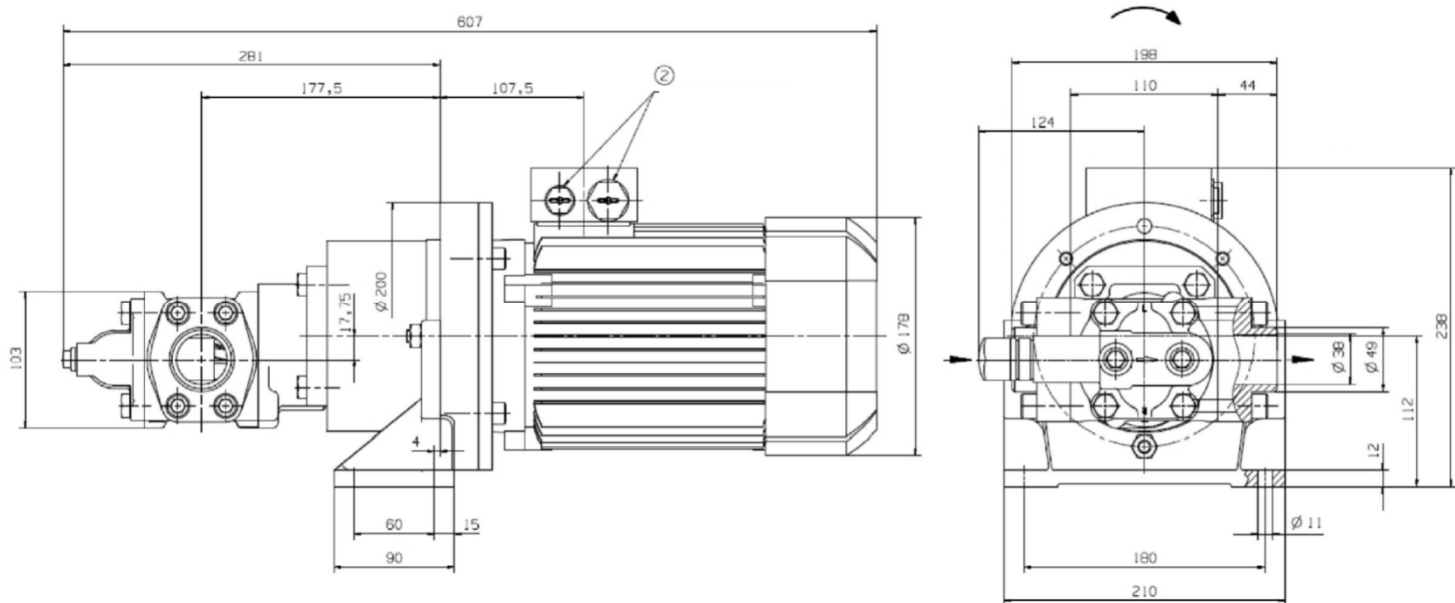

7. Dimensions of Pump 油泵尺寸

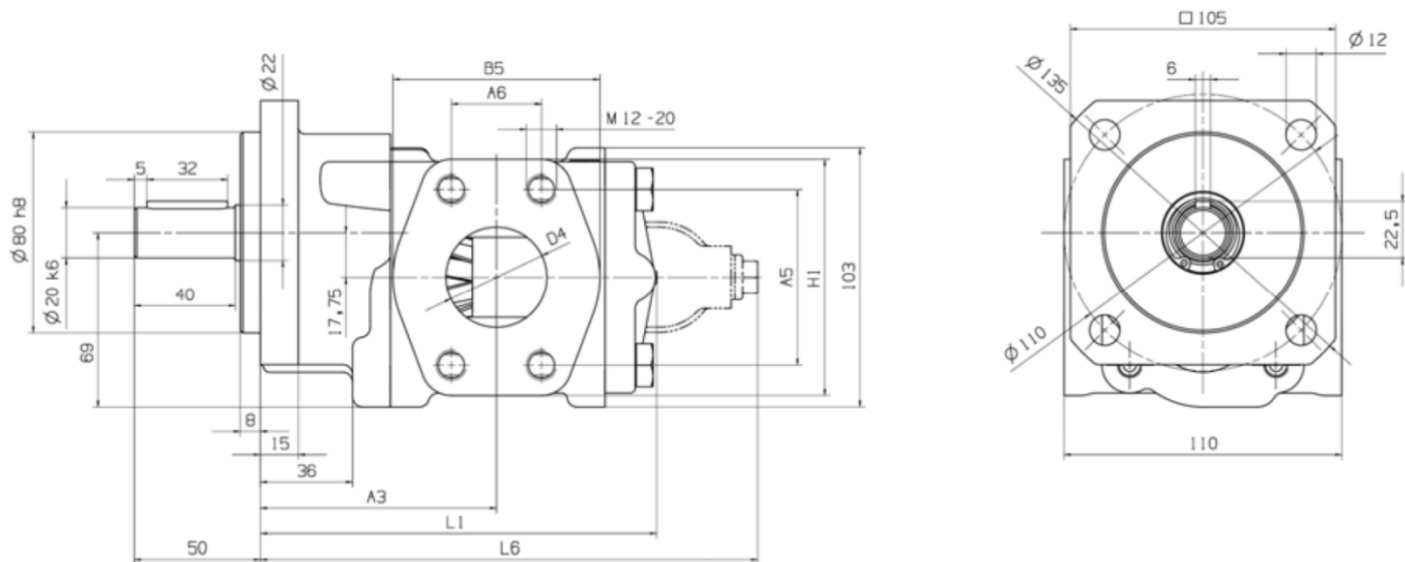

雨凡机械科技（上海）有限公司
Yufan Machinery Technology(Shanghai) Co., Ltd.

Lubricating Oil Pump 预润滑油泵

Option: pressure relief valve

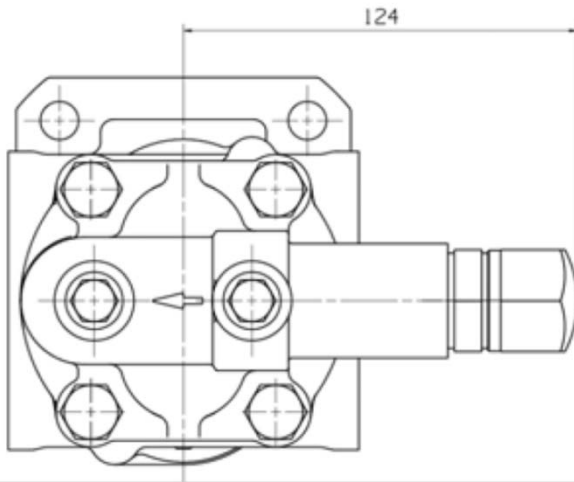

Vg[cm ³]	Dimensions [mm]									
	Suction and Pressure Connection						A3	L1	L6	Weight [kg]
	A5	A6	B5	D4	H1	Flange Size				
25	69.9	35.7	82	40	94	SAE 1-1/2"	93.5	157	197	8.1
40										



雨凡机械科技（上海）有限公司
Yufan Machinery Technology(Shanghai) Co., Ltd.

维护及维修

我们致力于为所销售的产品提供源自原厂的专业维修服务。每一项维修作业皆在我们专属的工厂内，由资历深厚、技术娴熟的专业人员精心开展。我们绝不只是简单地替换受损的零件，而是会对所有零件予以详尽检查，并向客户呈上最为优化的维修提议。不仅如此，我们更会将产品实施严格检测，全力确保其能够达成所需的功能要求。

We are committed to providing professional repair services from the original factory for the products we sell. Every maintenance task is carefully carried out by experienced and skilled professionals in our exclusive factory. We will not simply replace damaged parts, but will conduct a thorough inspection of all parts and provide customers with the most optimized repair proposals. Not only that, we will also conduct strict testing on our products to ensure that they meet the required functional requirements.

证书及荣誉

